

1 Technical data

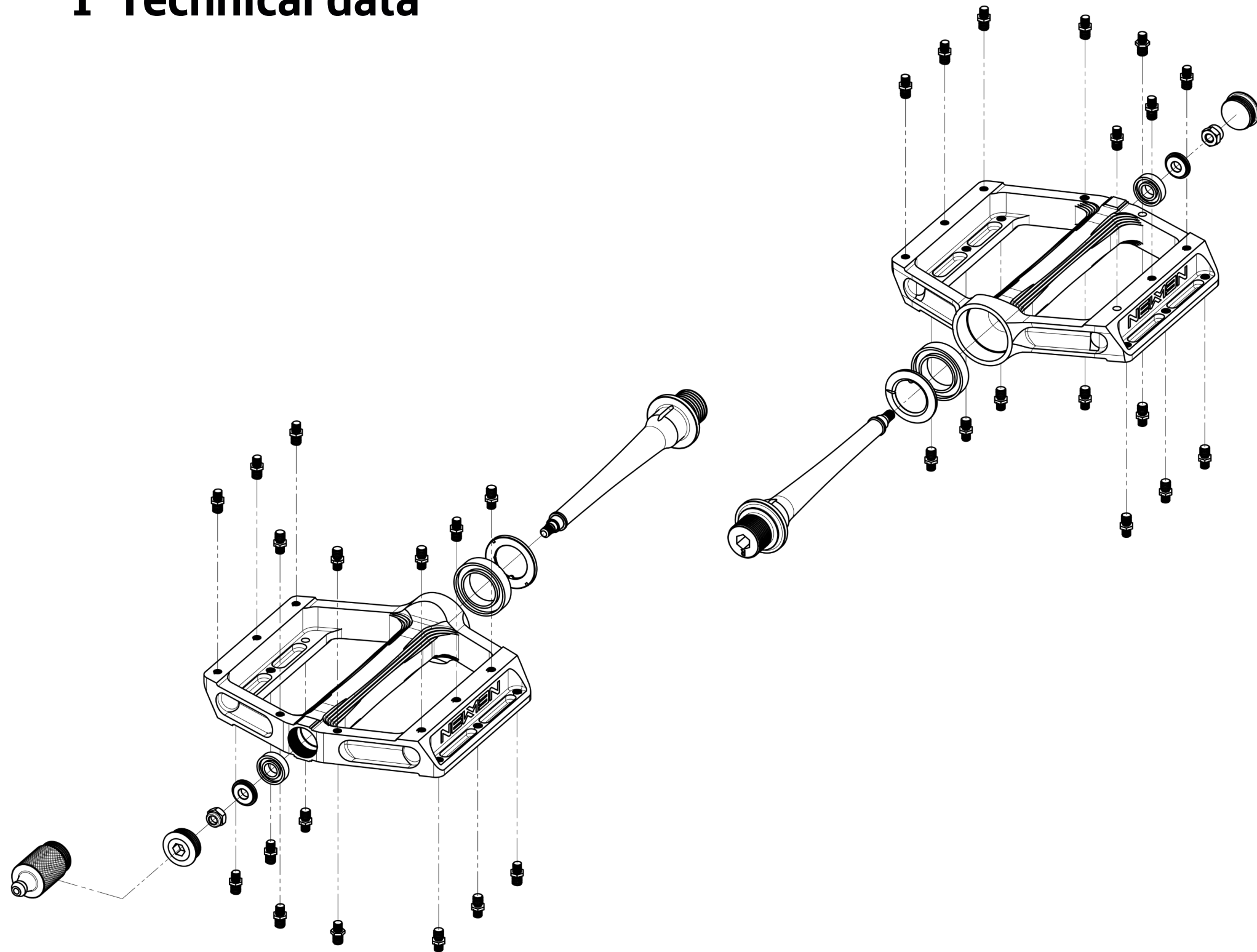

List of tools

Location used	Tool
Pedal Titanium Axle	6mm Hex key + torque wrench
Pedal Endcap	5mm Hex key + torque wrench
Pedal Titanium Axle	Grease gun

Spare parts

ITEM number	Product Name
90962	Service Kit Pedal
90961	Flat Pedal Replacement Pins

2 Maintenance

2.1 Pedal maintenance schedule

NEWMEN Beskar pedals are fully repairable and must be checked and serviced at regular intervals.

- Visual inspection every ride! Inspect the pedals for wear, damage or loose parts.
- Regrease pedals after every 30 hours of riding.
- Overhoul every 200 hours of riding.

2.2 Service the pedal

The pedal can be easily serviced with the NEWMEN service kit (item no. 90962).
The service kit for the NEWMEN Beskar pedal includes the following items:

- Zerk grease adapter
- Bearing BB FB 6x13x3,5 CN
- Bearing BB FB 15x24x5 CN LU
- Pedal M4 Nut right thread
- Pedal M4 Nut left thread
- Pedal Spring Washer





Unscrew the end cap from the pedal with a 5mm hex key.

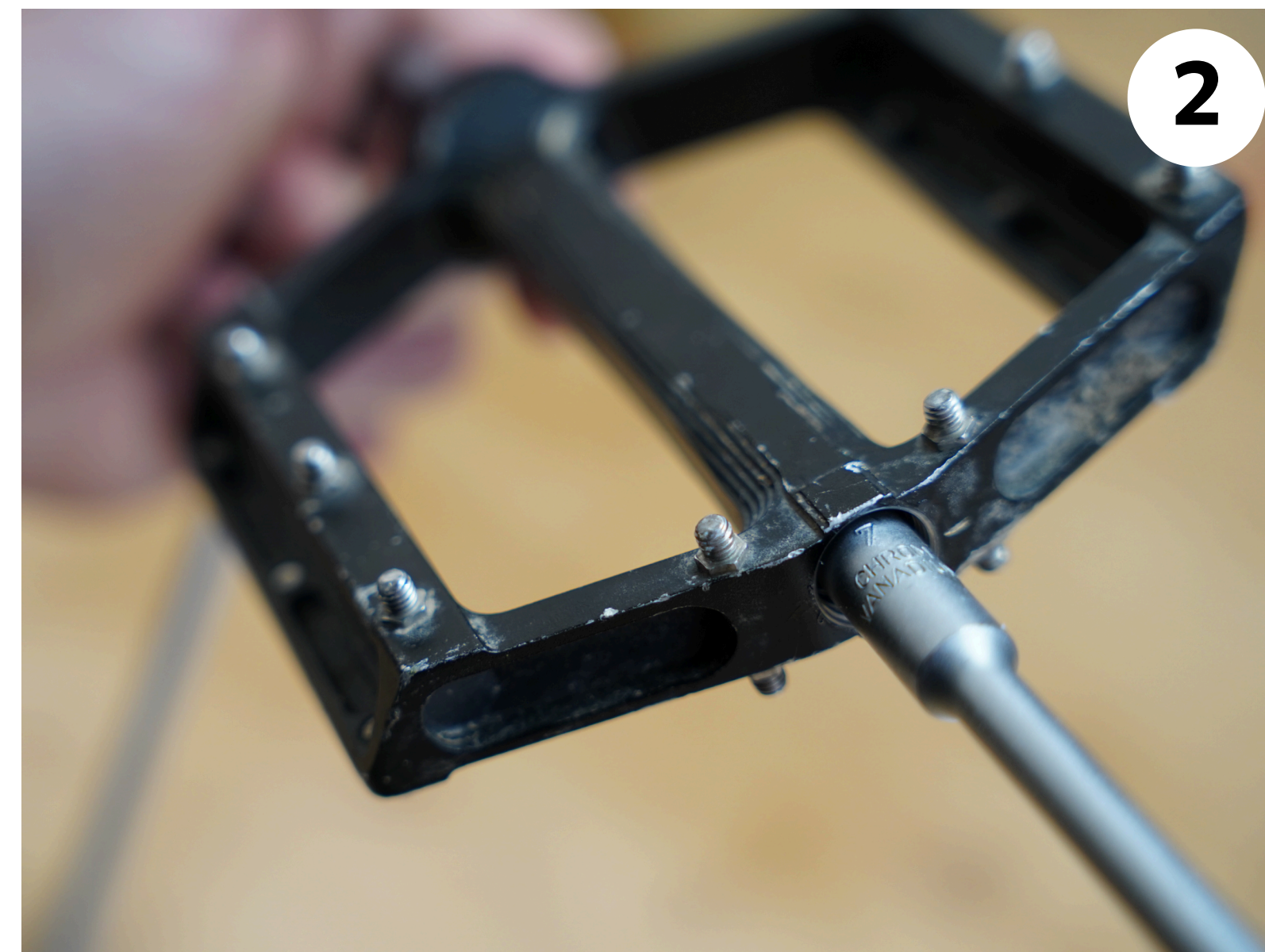

Unscrew the M4 nut on the outside of the pedal while holding inside with a 6mm hex key. Note: The nut for the left-hand side has a right-hand thread, the nut for the right-hand side has a left-hand thread.



Take the axle out of the pedal body.



Take the spring washer and the bearing out of the pedal body.



Take the spring washer and the bearing out of the pedal body on the other side.



Clean the pedal body and the spring washers and remove old grease.



Put the new spring washer on the axle. The bend must point away from the pedal thread.



Grease the new bearings lightly before fitting.



Insert the new bearing on the inside of the pedal body.



Insert the small bearing on the outside of the pedal body.



Thread the axle into the pedal body.



Insert the silver spring washer on the outside of the pedal body.



Tighten the M4 nut on the outside of the pedal by hand (!) while holding inside with a 6mm hex key. Note: The nut for the left-hand side has a right-hand thread, the nut for the right-hand side has a left-hand thread.



**Tighten the pedal M4 nut with a torque wrench to a maximum of 1.5 Nm!
Note: The nut for the left-hand side has a right-hand thread, the nut for the right-hand side has a left-hand thread.**



Screw the grease adapter onto the pedal by hand.



Take a grease gun and connect it to the grease nipple. Pump grease into the pedal until grease comes out of the other end of the pedal.



Remove the grease gun and the grease adapter. Remove excess grease from the pedal with a rag so that no dirt can adhere here.



Screw the end cap with a torque wrench back onto the pedal with 3Nm!